

DIN 1B Plain Taper Pins

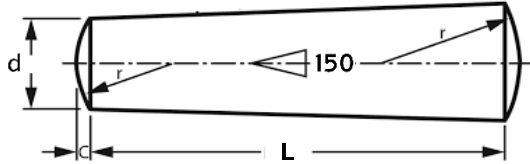

DIN 1B Plain Taper Pins													
Nominal Diameter dimension - d	1.5	2	2.5	3	4	5	6	8	10	12	14	16	20
Dimension - C	0.23	0.3	0.4	0.45	0.6	0.75	0.9	1	1.2	1.6	1.6	2	2.5
Lengths - L	6	6	6	6	6	10	10	20	28	30	36	36	40
	To 30	To 50	To 50	To 100	To 100	To 100	To 130	To 130	To 130	To 130	To 150	To 150	To 150

Length Tolerance To js15 (See Tolerance Bands Section)

Material
<i>Steel - Stainless Steel 303 - Stainless Steel 316</i>
<i>Plain Taper Pin With Turned Finish (Surface Roughness 3.2 Microns)</i>

INFORMATION AND DRAWINGS PROVIDED ARE FOR REFERENCE ONLY